

DIN 582

Norma

Nakrętka z uchem

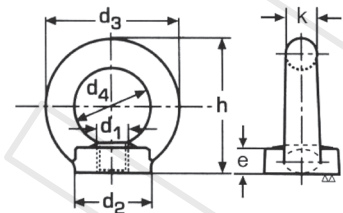

MATERIAŁY:

- Stal
- Stal nierdzewna A2, A4

POKRYCIA:

- Bez pokrycia
- Ocynk galwaniczny
- Ocynk ogniowy

RODZAJE GWINTÓW:

- Metryczne

| d1 | d2 | d3 | d4 | h | e | k |
|--------------|-----|-----|-----|-----|-----|----|
| M 6* | 20 | 36 | 20 | 36 | 8,5 | 8 |
| M 8* | 20 | 36 | 20 | 36 | 8,5 | 8 |
| M 10* | 25 | 45 | 25 | 45 | 10 | 10 |
| M 12 | 30 | 54 | 30 | 54 | 11 | 12 |
| M 16 | 35 | 63 | 35 | 63 | 13 | 14 |
| M 20 | 40 | 72 | 40 | 72 | 16 | 15 |
| M 22* | 45 | 81 | 45 | 81 | 18 | 16 |
| M 24 | 50 | 90 | 50 | 90 | 20 | 20 |
| M 27* | 50 | 90 | 50 | 90 | 20 | 20 |
| M 30 | 65 | 108 | 60 | 108 | 25 | 24 |
| M 33* | 65 | 108 | 60 | 108 | 25 | 24 |
| M 36 | 75 | 126 | 70 | 126 | 30 | 28 |
| M 39* | 75 | 126 | 70 | 126 | 30 | 28 |
| M 42 | 85 | 144 | 80 | 144 | 35 | 32 |
| M 45* | 85 | 144 | 80 | 144 | 35 | 32 |
| M 48 | 100 | 166 | 90 | 166 | 40 | 38 |
| M 52* | 100 | 166 | 90 | 166 | 40 | 38 |
| M 56 | 110 | 184 | 100 | 184 | 45 | 42 |
| M 64 | 120 | 206 | 110 | 206 | 50 | 48 |

* Wymiary w tabeli to wymiary standardowe

** Inne na zapytanie